

COMMUNITY MEETING

Please attend a Community Meeting hosted by the March Joint Powers Authority to learn about the proposed Meridian D-1 Gateway Aviation Center Project

Tuesday
June 18, 2024
6 p.m. – 7:30 p.m.

March Joint Powers Authority
WMWD Training Room, Suite 120
14205 Meridian Parkway
Riverside, CA 92518

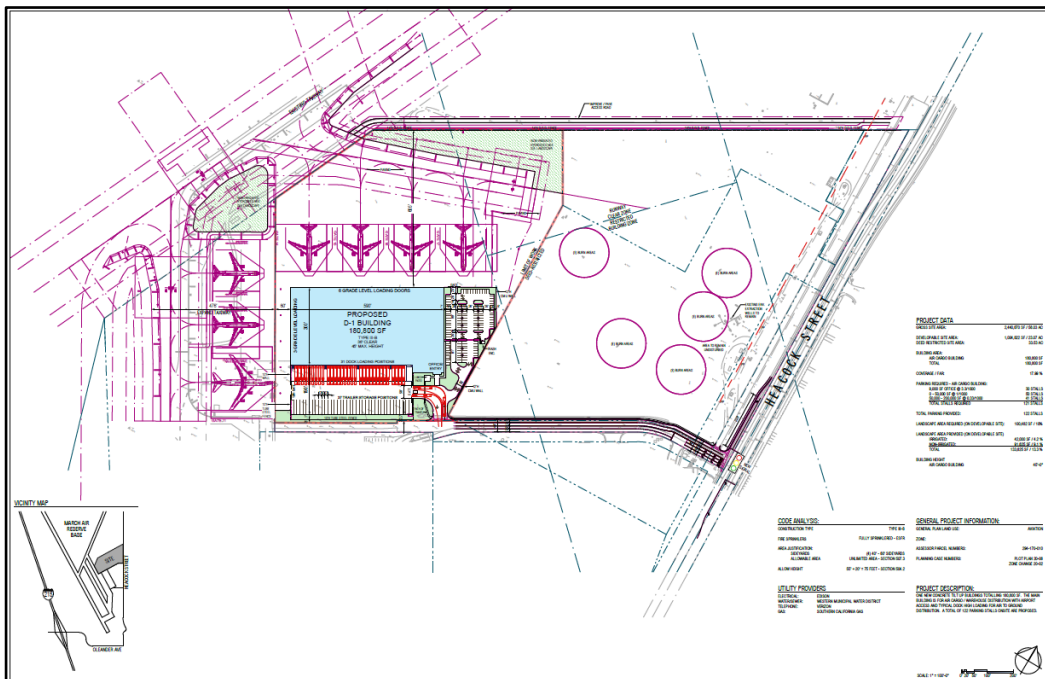

The proposed Meridian D-1 Gateway Aviation Center Project consists of an Air Cargo Center Component and Off-Site Component located on approximately 46 acres. The Air Cargo Center Component would include the development of a gateway air freight cargo center, including an 180,800-square-foot cargo building, taxiway/taxiway and parking improvements, within an approximately 34-acre site within March Inland Port Airport under the jurisdiction of March Joint Powers Authority. The Off-Site Component would be constructed on approximately 12 acres and would include taxiway and taxiway construction, widening, and realignment; storm-drain extensions; and a perimeter patrol road with security fencing within March Air Reserve Base. The proposed project would also require a zoning designation and a plot plan approval.



Visit our website:
<https://marchjpa.com/>

Visit the Meridian D-1 Project webpage:
<https://marchjpa.com/meridian-d1-gateway-aviation-center-project/>